



مصنع سهيل للتشكيلات المعدنية ذ.م.م

SUHAIL METAL FORMINGS FACTORY W.L.L

# SCAFFOLDING CATALOGUE

# TABLE OF CONTENT

## CONTENTS

<b>HISTORY</b>	<b>4</b>
<b>CHOICE</b>	<b>5</b>
<b>QUALITY</b>	<b>6</b>
<b>INNOVATION</b>	<b>7</b>
<b>NASK SCAFFOLDING</b>	<b>8</b>
<b>OTHER POSSIBLE PRODUCTS</b>	<b>16</b>





# A LITTLE BIT OF HISTORY

Suhail Metal Formings Factory is a thriving Qatari factory in the field of steel systems and profiles for the building sector. Suhail offers solutions for profiles and accessories dedicated to scaffoldings & formworks indoors and outdoors. The wide range of products and services that it provides has built for the company excellent reputation in the market. Thanks to the manufacturing based on quality, choice, and innovation, while using cutting-edge technology to manufacture scaffolding.



# CHOICE

To respond to any request, Suhail offers a wide range of profiles and accessories using steel material and standardized product dimensions that are modular for ease of erection and dismantling. Through advanced production lines, and huge internal and external storage capacity, NASK product range can satisfy customers' requests rapidly. And with the help of our extensive distribution network, we can provide our products all over our main market in Qatar, the gulf region, and the middle east.



# QUALITY

Both at the level of quality of the offered products and the raw materials used in manufacturing, Suhail honors its commitment to provide the clients with products of an impeccable level of quality. And this commitment extends to choosing our suppliers and partners who we select for their capabilities in their field. This constant search for the best allows us to follow the well-known standards, and make sure that our products are of utmost quality, with extensive quality testing during the manufacturing and finishing of the products.



# INNOVATION

As we strive to supply the market with highest quality products, we continually look for improved and innovative manufacturing methods that could reduce the price while maintaining the highest quality, this includes the extensive use of engineering and design software to fulfill customer needs, and make sure they are satisfied with the resulting benefits of using our products.



# KAM'A SHORING & SCAFFOLDING

## KAM'A STANDARDS

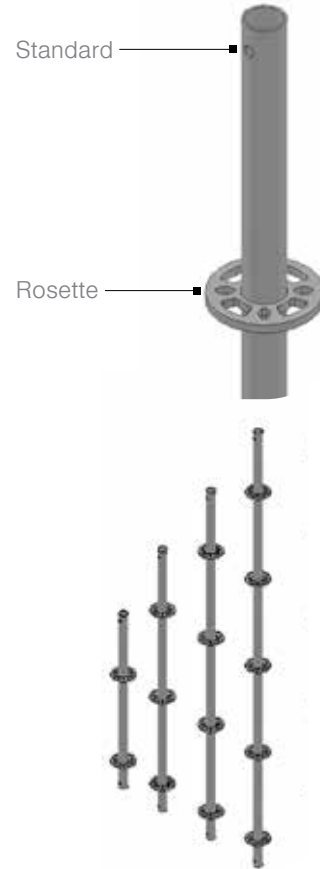
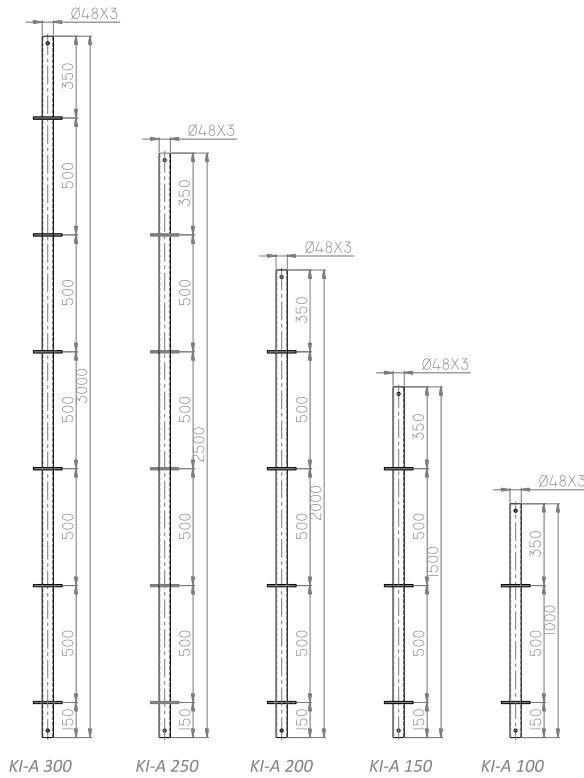

## KAM'A LEDGER & TRANSOM

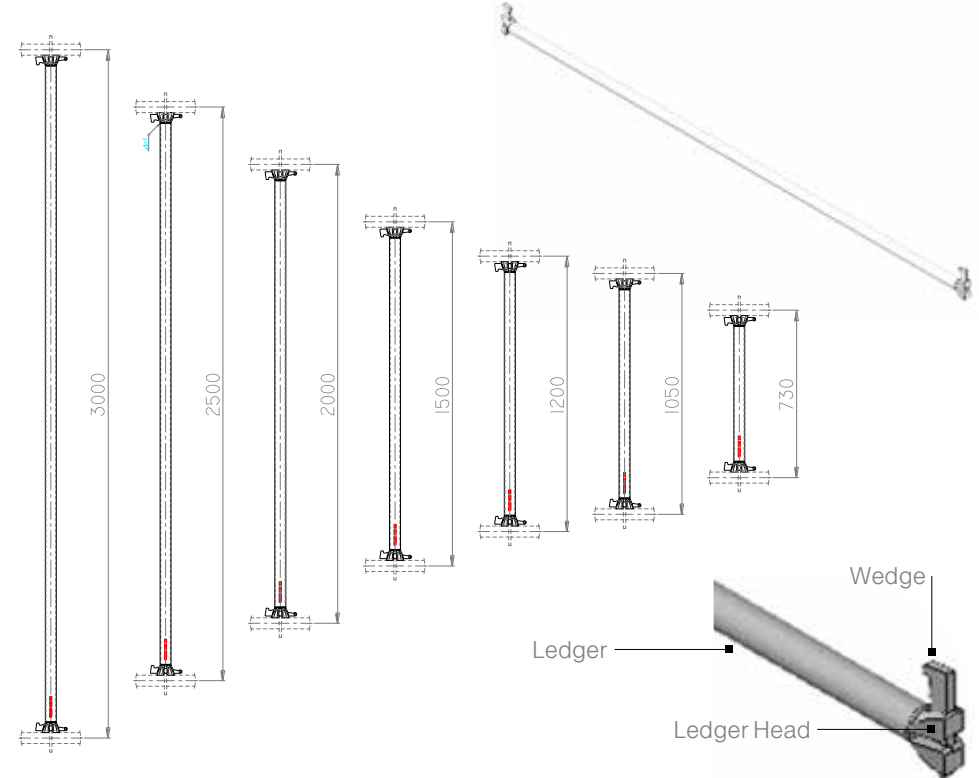

Stock Name	Stock Code	Material Description	Unit Weight (kg)
NKI-A G 50	N010 118 00050	Kam'a Standards, 50	2.38
NKI-A G 100	N010 118 00100	Kam'a Standards, 100	4.46
NKI-A G 150	N010 118 00150	Kam'a Standards, 150	7.15
NKI-A G 200	N010 118 00200	Kam'a Standards, 200	9.54
NKI-A G 250	N010 118 00250	Kam'a Standards, 250	11.92
NKI-A G 300	N010 118 00300	Kam'a Standards, 300	14.31

Stock Name	Stock Code	Material Description	Unit Weight (kg)
NKI-Y G 73	N010 118 01073	Kam'a Ledger & Transom 73	3.12
NKI-Y G 105	N010 118 01105	Kam'a Ledger & Transom 105	4.33
NKI-Y G 150	N010 118 01150	Kam'a Ledger & Transom 150	5.99
NKI-Y G 200	N010 118 01200	Kam'a Ledger & Transom 200	7.84
NKI-Y G 250	N010 118 01250	Kam'a Ledger & Transom 250	9.69
NKI-Y G 300	N010 118 01300	Kam'a Ledger & Transom 300	11.2



## TRANSOM

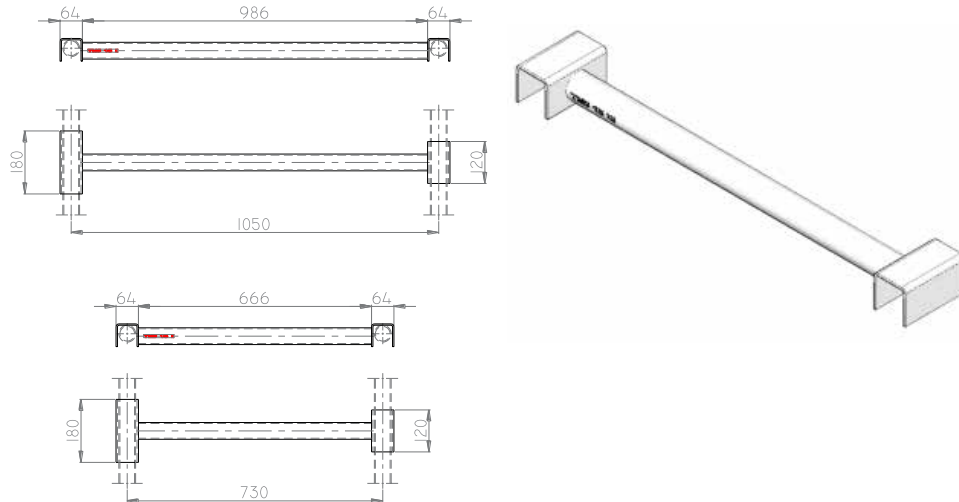

Stock Name	Stock Code	Material Description	Unit Weight (kg)
NKI-G G 73	N010 118 02073	Transom 73	3.12
NKI-S G 105	N010 118 02105	Transom 105	4.33

## HOOK TYPE - TIE EQUIPMENT

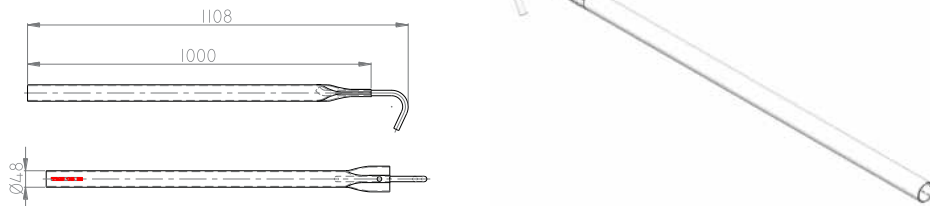

Stock Name	Stock Code	Material Description	Unit Weight (kg)
NSF-B G 100	N010 122 02667	Hook Type Tie Equipment 100	4.00
NSF-B G 150	N010 122 02668	Hook Type Tie Equipment 150	5.50

## DIAGONAL BRACING



Stock Name	Stock Code	Material Description	Unit Weight (kg)
NKI-C G 150X200	N010 118 03150	Kam'a Diagonal 150x200	9.70
NKI-C G 200X200	N010 118 03200	Kam'a Diagonal 200x200	10.62
NKI-C G 250X200	N010 118 03250	Kam'a Diagonal 250x200	12.05
NKI-C G 300X200	N010 118 03300	Kam'a Diagonal 300x200	13.32

## PARAPET - TIE EQUIPMENT

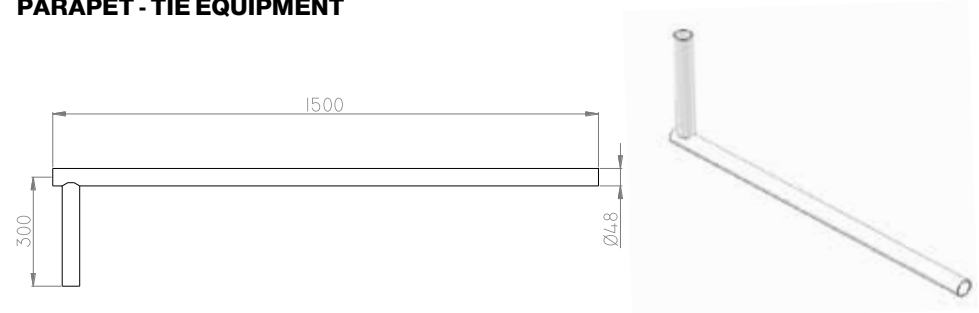

Stock Name	Stock Code	Material Description	Unit Weight (kg)
NIS-B G	N010 122 00132	Parapet-Tie Equipment	3.70

**KAM'A STANDARD CONNECTOR**

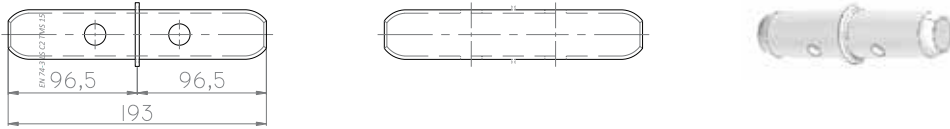

Stock Name	Stock Code	Material Description	Unit Weight (kg)
NKP-E B	N010 017 01680	Scaffolding connectors	0.60

**TOE BOARD (STEEL)**

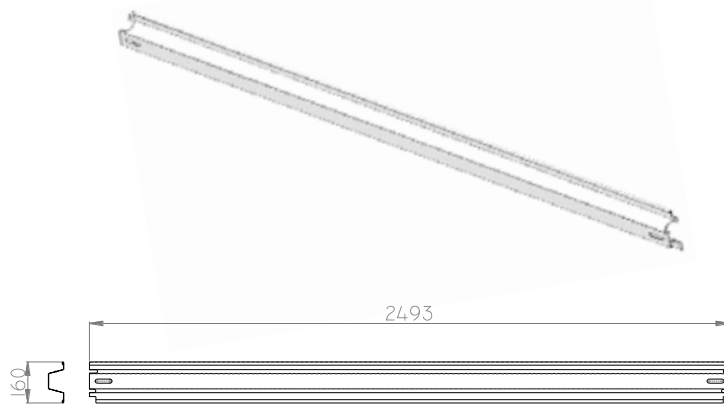

Stock Name	Stock Code	Material Description	Unit Weight (kg)
NKI-S G 73	N010 117 02679	Kam'a Steel Toeboard, 73	1.90
NKI-S G 105	N010 117 02681	Kam'a Steel Toeboard, 105	2.75
NKI-S G 150	N010 117 02683	Kam'a Steel Toeboard, 150	3.94
NKI-S G 200	N010 117 02684	Kam'a Steel Toeboard, 200	5.26
NKI-S G 250	N010 117 02685	Kam'a Steel Toeboard, 250	6.60
NKI-S G 300	N010 117 02686	Kam'a Steel Toeboard, 300	7.50

**KICKER HOLDER**

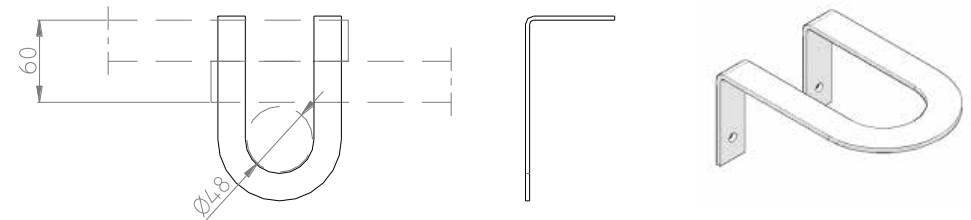

Stock Name	Stock Code	Material Description	Unit Weight (kg)
NSF-T B	N010 022 02679	Toeboard Frame Connector	0.18

**BAND PLATFORM**

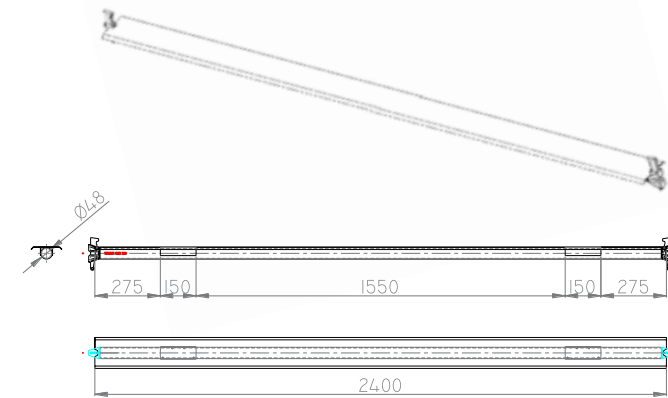

Stock Name	Stock Code	Material Description	Unit Weight (kg)
NKP-B G 112	N010 120 313112	Band Platform 120	2.10
NKP-B G 115	N010 120 313115	Band Platform 150	2.45
NKP-B G 120	N010 120 313120	Band Platform 200	3.25
NKP-B G 125	N010 120 313125	Band Platform 250	4.00
NKP-B G 130	N010 120 313130	Band Platform 300	4.95



## FACADE SCAFFOLD STAIR

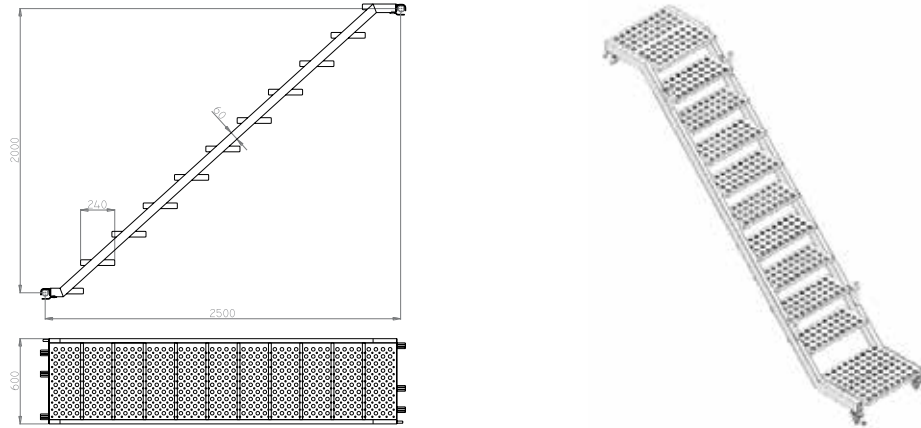

Stock Name	Stock Code	Material Description	Unit Weight (kg)
NKP-M G	N010 117 01690	Scaffold Stairs	49.50

## STEEL PLATFORM

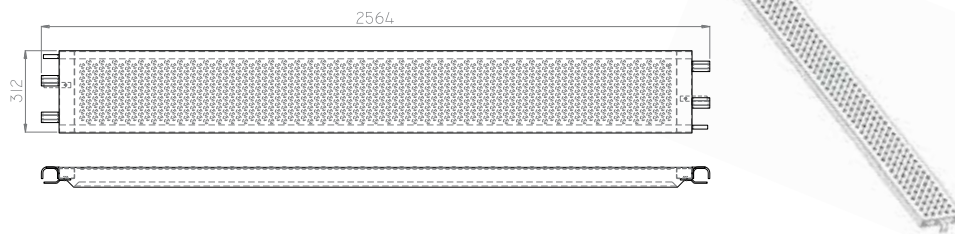

Stock Name	Stock Code	Material Description	Unit Weight (kg)
NKL-B G 312	N010 120 13012	Steel Platform 312, 30x125 cm	10.80
NKL-B G 315	N010 120 13015	Steel Platform 315, 30x150 cm	12.50
NKL-B G 320	N010 120 13020	Steel Platform 320, 30x200 cm	15.90
NKL-B G 325	N010 120 13025	Steel Platform 325, 30x250 cm	19.30
NKL-B G 330	N010 120 13030	Steel Platform 330, 30x300 cm	22.70

## ACCESS DECK WITH LADDER

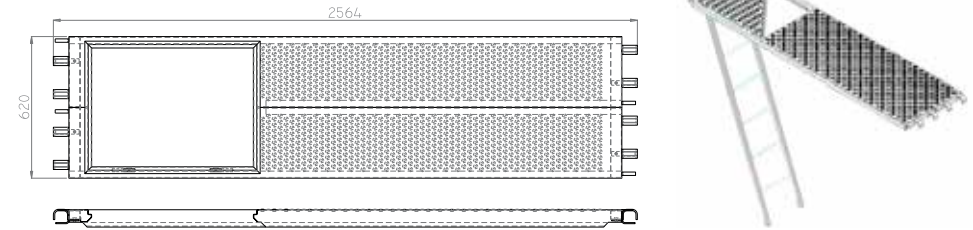

Stock Name	Stock Code	Material Description	Unit Weight (kg)
NMP-B G 625	N010 120 16025	Access Deck with Ladder 625, 60X250	48.40
NMP-B G 630	N010 120 16030	Access Deck with Ladder 630, 60X330	54.40

## BASE SPINDLE

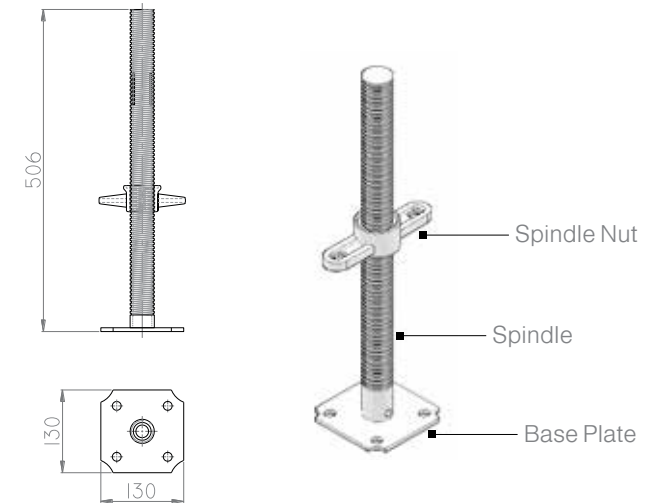

Stock Name	Stock Code	Material Description	Unit Weight (kg)
NMA-A G 38X750	N010 113 03807	Base Spindle, ø38x750, Tube	3.35
NMA-A G 48X1000	N010 113 04801	Base Spindle, ø48x1000, Tube	6.70



### STEEL PROPS

Material Description	Length(m)
Spanish Type, Inner/outer Dia 40/48 mm	3 and 4
Italian type, Inner/outer Dia 48/56 mm	3 and 4
German Type, Inner/outer Dia 48/60 mm	3 and 4
German Type, Inner/outer Dia 63.5/76.1 mm	3,4 and 5

“Steel props,” often referred to as “steel props,” are adjustable, telescopic supports used in construction and civil engineering projects. These props are designed to provide temporary support for formwork, ceilings, walls, and other structural elements during construction or renovation.

#### Material:

Typically made from steel, chosen for its high strength and durability. The steel is often galvanized or painted to prevent rust and corrosion.

#### Design:

Steel props are designed to be lightweight yet strong, allowing for easy transportation and installation. They are usually telescopic to accommodate different heights and can be adjusted easily with the adjusting nut.

#### Load Capacity

The load capacity of steel props varies depending on their size, design, and material thickness. Manufacturers specify the safe working load (SWL) for different extension lengths. It is crucial to adhere to these specifications to ensure safety on the construction site.



مصنع سهيل للتشكيلات المعدنية ذ.م.م  
SUHAIL METAL FORMINGS FACTORY W.L.L

**NASK SCAFFOLDING**

منتج قطري  
QATARI PRODUCT



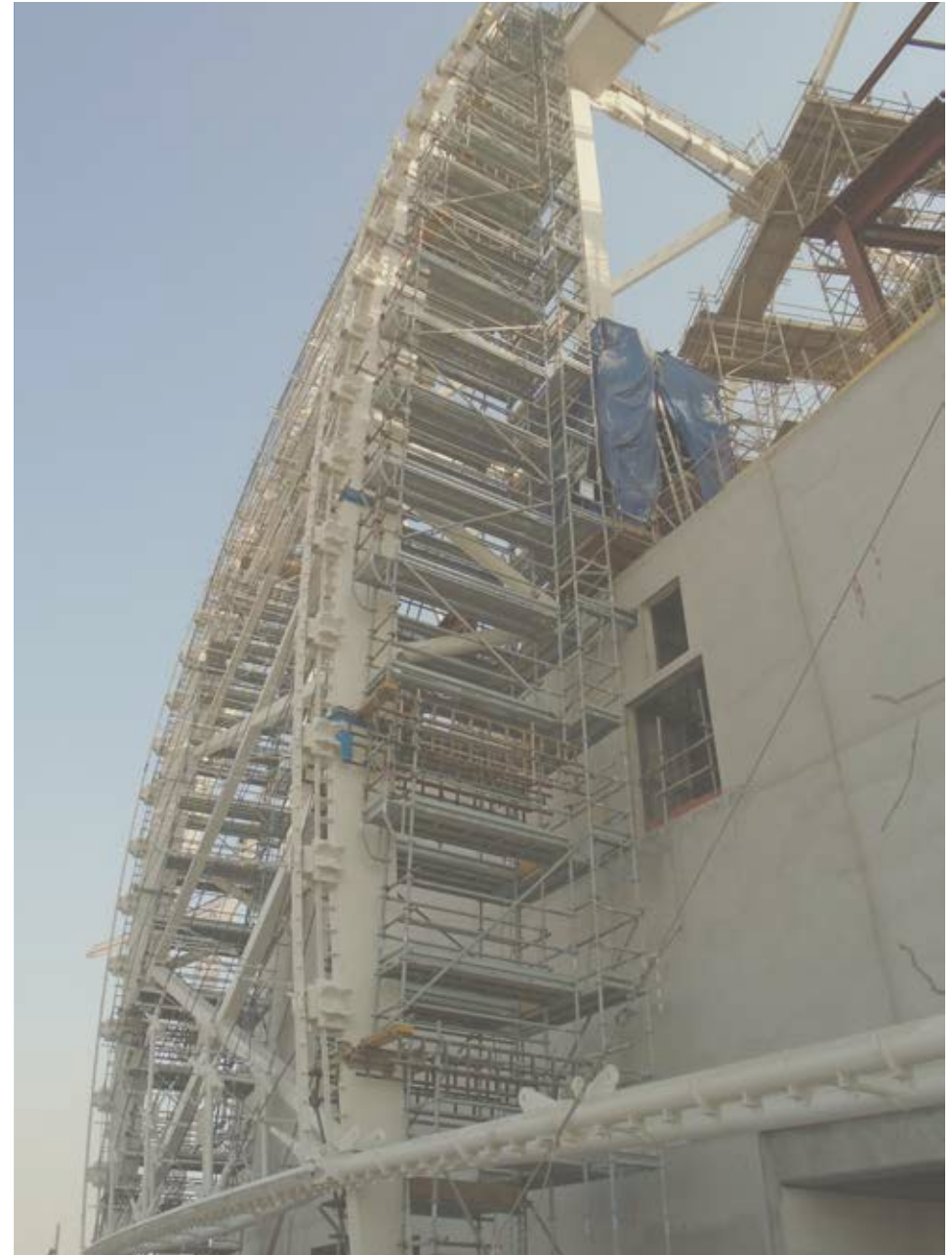



مصنع سهيل للتشكيلات المعدنية ذ.م.م.  
SUHAIL METAL FORMINGS FACTORY W.L.L.

NASK SCAFFOLDING

منتج قطري  
QATARI PRODUCT







## OTHER POSSIBLE PRODUCTS

### HEAT EXCHANGER



### PRESSURE VESSEL





## OTHER POSSIBLE PRODUCTS

### SILOS



### STEEL PLATFORM



### TANKS





مصنع سهيل للتشكيلات المعدنية ذ.م.م

SUHAIL METAL FORMINGS FACTORY W.L.L

- 📍 Msheireb, Building T05, 5<sup>th</sup> Floor, P.O. Box 8839, Doha, Qatar  
☎ +974 4427 5552  
📞 +974 4427 5554  
✉ info@suhailindustries.com  
🌐 www.suhailindustries.com

**YOUR  
RELIABLE  
PARTNER**

📘 📷 in X @suhailindustries